

East Fremantle Lawn Tennis Club - Shaded Spectator Tunnel

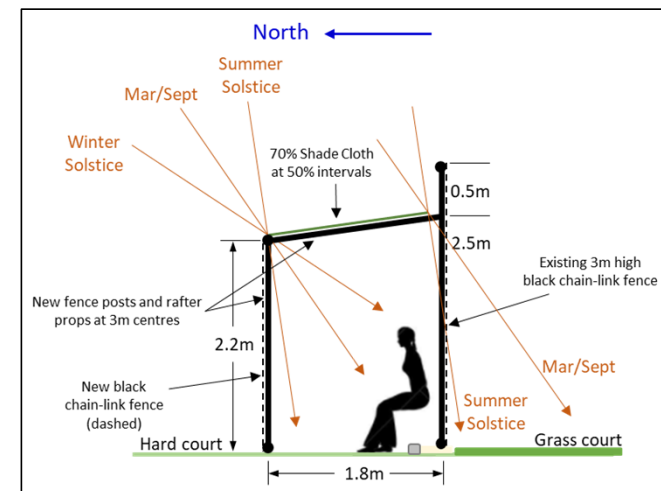

Current Situation

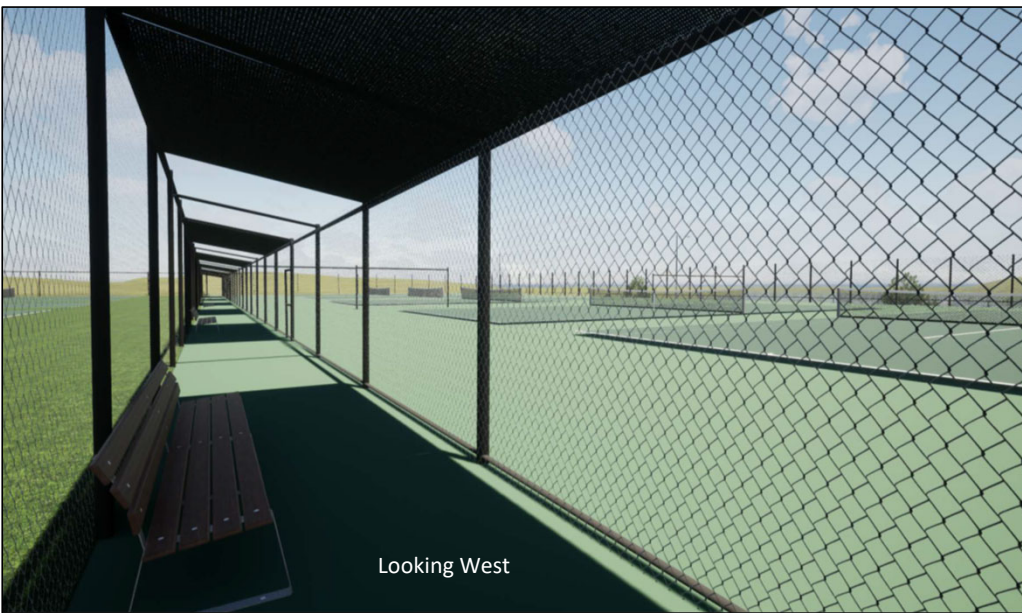

Lack of permanent shade and seating for spectators has been a concern for EFLTC and our patrons for many years, now amplified as we are experiencing a significant increase in the number of young juniors in coaching clinics and camps, and competing on weekends, plus increased membership and rapidly increasing casual court hire.

Current Situation

Portable shade is available courtesy of two portable gazebo's (much appreciated during large events such as tournaments), but space is limited and a long way from the far courts for parents and team-mates watching.

The gazebo's are not practical for day-to-day operations such as coaching, and general hire due to set-up effort. We can't leave them up permanently due to the risk of theft.



East Fremantle Lawn Tennis Club – Carpark Fence

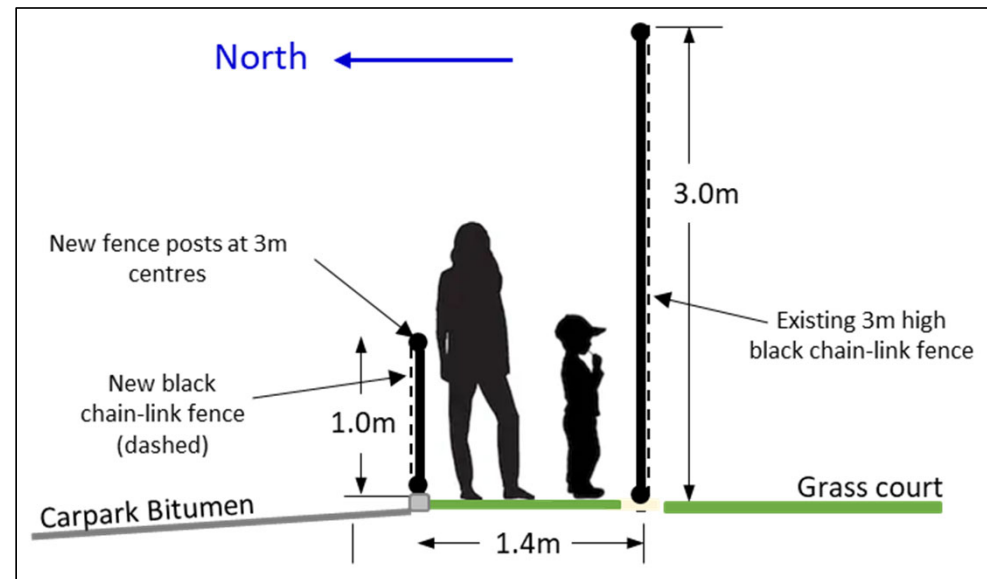
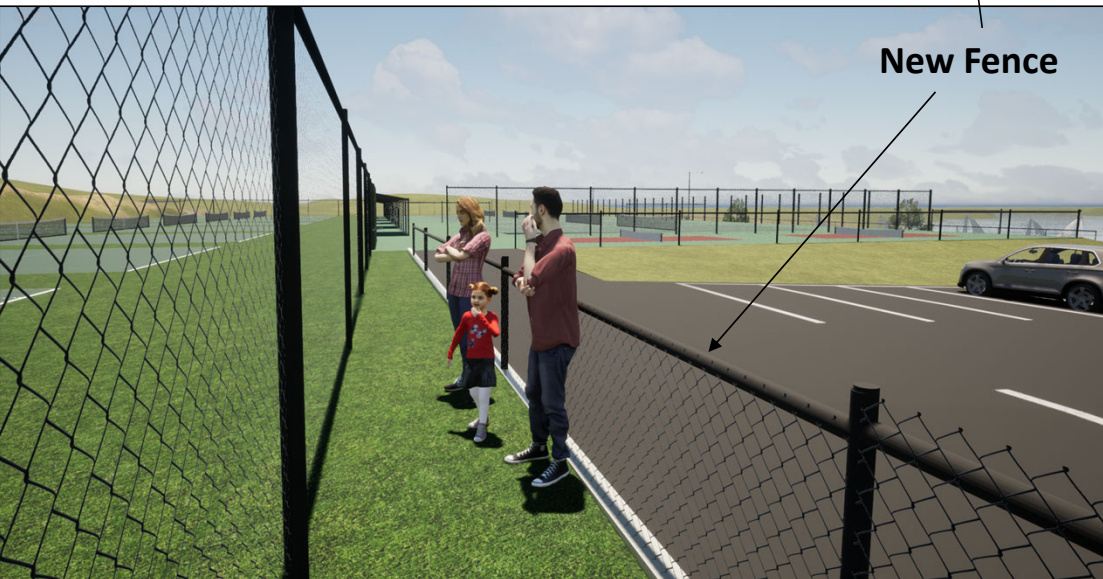

Current Situation



Hotshot kids, young pennant players, and spectators must traverse the Club carpark between the Clubrooms and the Tennis Courts. This creates a significant safety risk, particularly for small children.

The proposed new carpark fence and grassed walkway will eliminate this risk.



View from Preston Point Road Level



Shaded Spectator Tunnel

North
↑

Jerrat Drive

