

7 Riverside Rd. East Fremantle

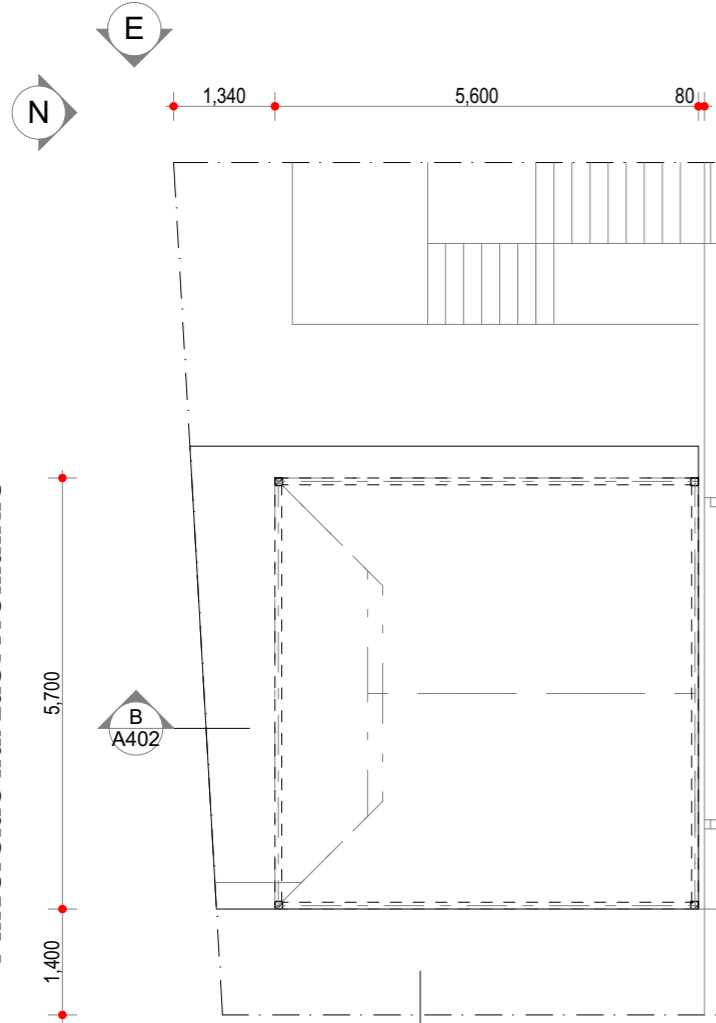

C.O.T. 1647
Lot 8



Proposed carport roof pitch reduced to 14 degrees to fit beneath existing verandah beam

north
1:100

east
1:100

CL. 3860 (2400mm)

FL. 1460 (0mm)

west
1:100

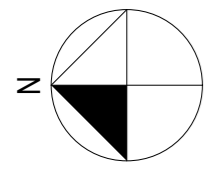

Proposed Carport Plan
1:100

john
Chisholm design
environmental heritage contemporary
0408 833 399 jc@jonchisholm.com jonchisholm.com

nabd NATIONAL ASSOCIATION OF BUILDING DESIGNERS
BDWA BUILDING DESIGNERS ASSOCIATION OF WESTERN AUSTRALIA INC.
© Copyright

Project:
**Proposed Carport
7 Riverside Rd.
East Fremantle**

Drawing:
Proposed Carport Plan

1	issued for planning	07/6/2022
REV.	AMENDMENT	DATE

Date:	7/06/2022	Drwn:	JC
Job No:	2224	Dwg No.:	A201
The builder must verify all dimensions on site before commencing any work or shop dwgs.			



north west



north east